

Detailed Map of the B&O Trail in Hendricks and Marion County

Draft Version – June 1, 2023

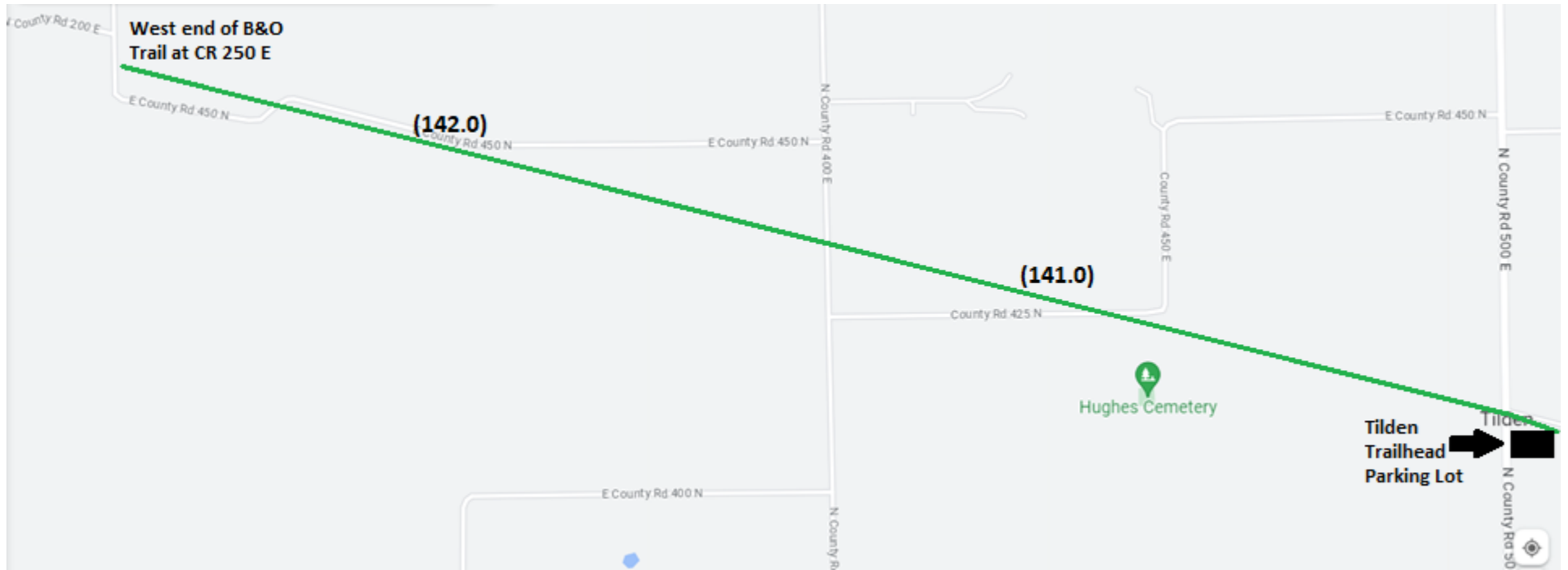

01 --- 02 --- 03 --- 04 --- 05 --- 06 --- 07 --- 08 --- 09 --- 10 --- 11 --- 12 --- 13 --- 14 --- 15 --- 16 --- 17 --- 18 --- 19 --- 20

Map 1 – The developed B&O Trail currently starts at the western most end at County Road 250 E in Hendricks County. The trail generally follows the former B&O railroad corridor in Hendricks & Marion County and runs diagonally in a southeasterly direction. The map panels shown here each represent approximately a 2-mile section of trail. The red numbers shown below each map panel are to help provide reference points along the linear trail and to help show how each panel overlaps with one another. Mile markers in Hendricks County for 911 locations are shown with black numbers in parentheses. These numbers are aligned with the original mileage markers used by the railroad. They represent the rail line’s distance from Cincinnati.

Trail crossings shown here include: CR 450 N, CR 400 E, CR 425 N and CR 500 E. The partially finished Tilden Trailhead parking lot is located on the east side of CR 500 E. This parking lot is large enough to accommodate horse trailers. This section of trail is owned and managed by the B&O Trail Association (BOTA). BOTA is an all-volunteer, non-profit group.

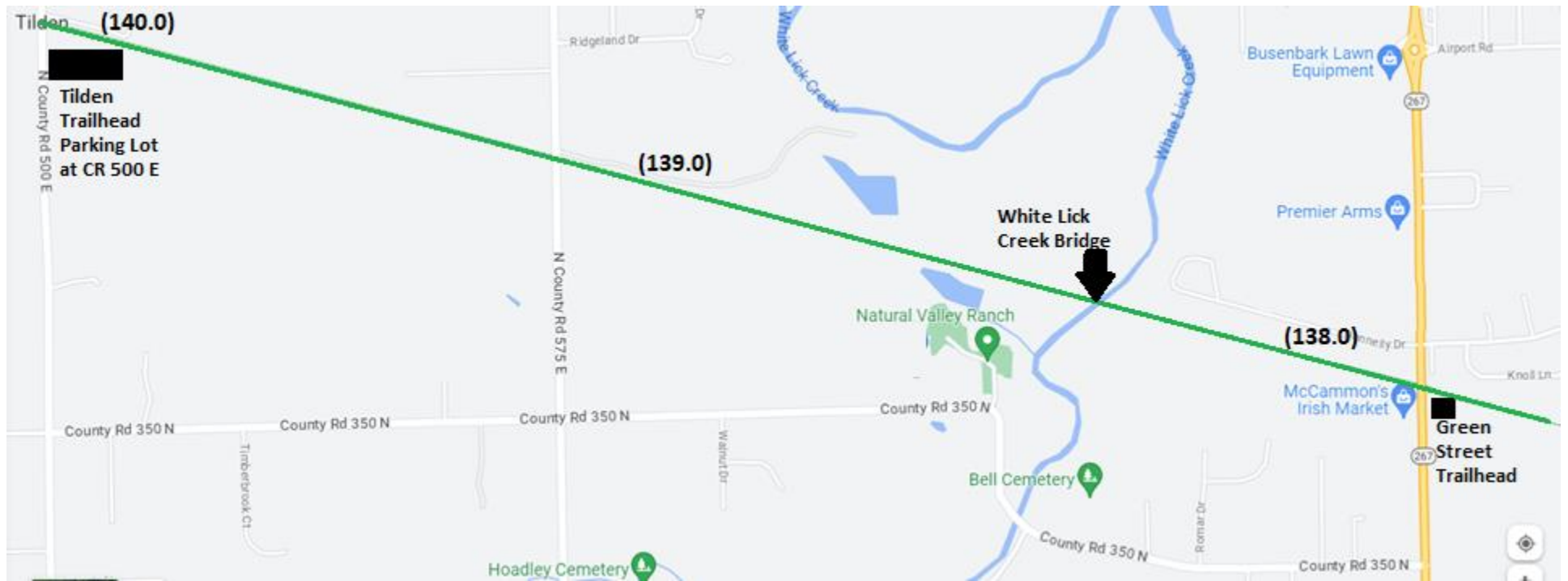

19 --- 20 --- 21 --- 22 --- 23 --- 24 --- 25 --- 26 --- 27 --- 28 --- 29 --- 30 --- 31 --- 32 --- 33 --- 34 --- 35 --- 36 --- 37 --- 38 ---

Map 2 – This section of trail in Hendricks County stretches from CR 500 E to Green Street in Brownsburg.

Trail crossings shown here include: CR 500 E, CR 575 E, White Lick Creek bridge and Green Street. There is a user-activated HAWK signal at Green Street to aid in crossing this road. There is also a small trailhead parking lot and shelter located on the east side of Green Street. Areas west of Green Street are owned and managed by the B&O Trail Association. The trail east of Green Street is owned and managed by the Town of Brownsburg,

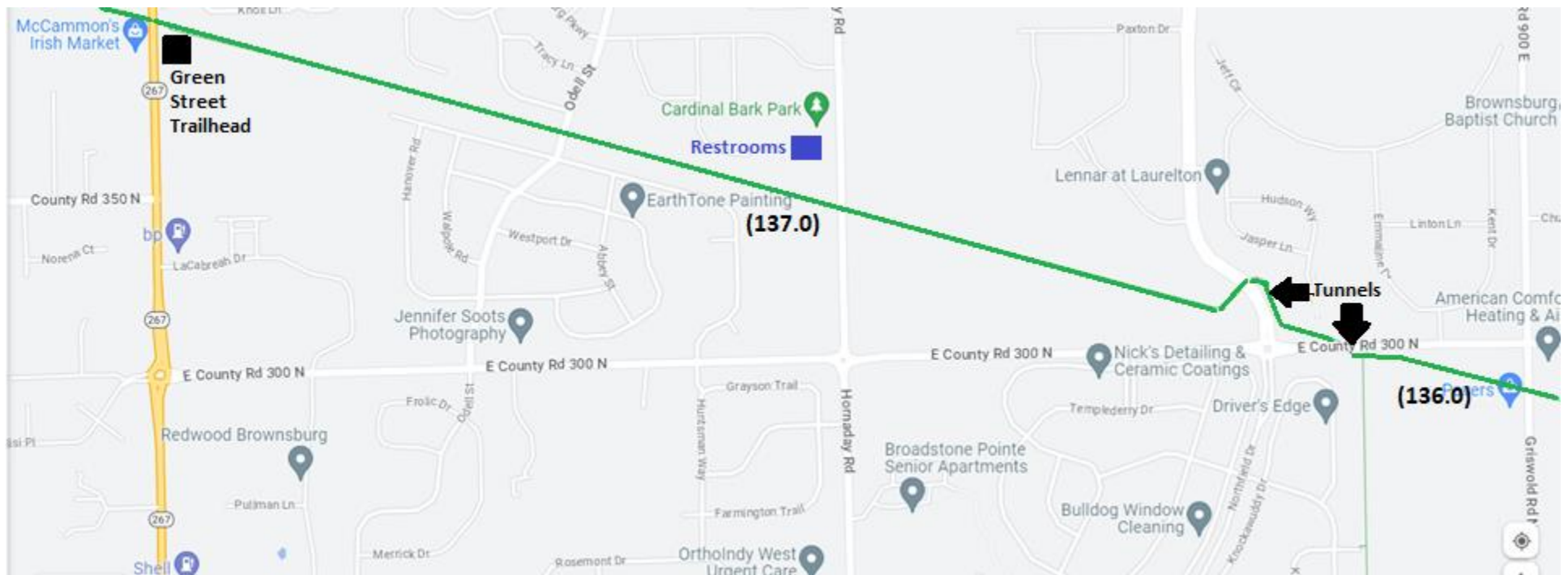

--- 35 --- 36 --- 37 --- 38 --- 39 --- 40 --- 41 --- 42 --- 43 --- 44 --- 45 --- 46 --- 47 --- 48 --- 49 --- 50 --- 51 --- 52 --- 53 --- 54

Map 3 – This section of trail in Hendricks County stretches from Green Street to CR 900 E (Griswold Road). Besides the Green Street Trailhead, there is also parking and restrooms available at Cardinal Park on the north side of the trail just west of Hornaday Road.

Trail crossings shown here include: Green Street, Odell Street, Hornaday Road, Northfield Drive (tunnel), CR 300 N (tunnel) and CR 900 E. This section of trail is owned and managed by the Town of Brownsburg.

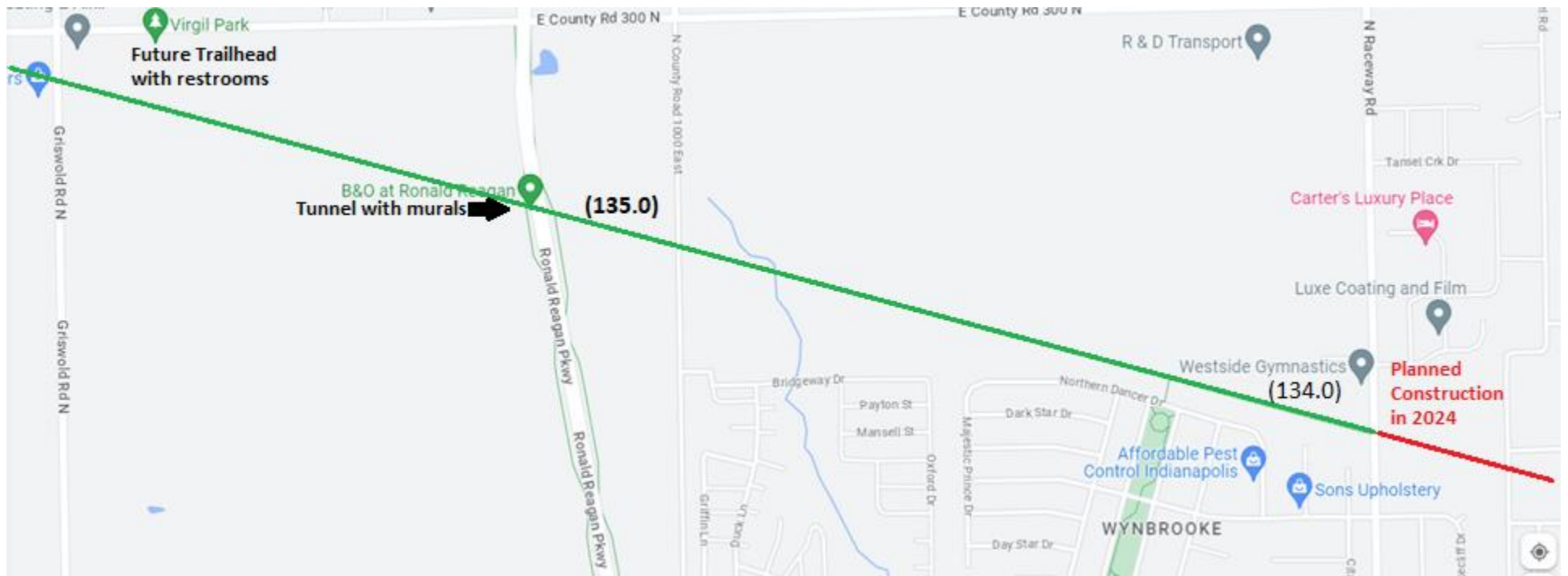

- 53 --- 54 --- 55 --- 56 --- 57 --- 58 --- 59 --- 60 --- 61 --- 62 --- 63 --- 64 --- 65 --- 66 --- 67 --- 68 --- 69 --- 70 --- 71 --- 72 -

Map 4 – This section of developed trail in Hendricks County stretches from CR 900 E (Griswold Road) to Raceway Road. A future trailhead called Virgil Park is being constructed just east of CR 900 E on the north side of the trail. It will provide parking and rest room facilities when completed in the fall of 2023. It will be accessible by car just off of CR 300 N. There are two nodes on either side of the Ronald Reagan Parkway (RRP) tunnel where the RRP trail intersects with the B&O Trail. Raceway Road represents the county line separating Hendricks County and Marion County. The undeveloped trail east of Raceway Road in Marion County is currently planned for construction in 2024.

Trail crossings shown here include: CR 900 E, Ronald Reagan Parkway (tunnel), CR 1000 E and Raceway Road. The trail west of Ronald Reagan Parkway tunnel is owned and managed by the Town of Brownsburg. The trail east of the Ronald Reagan Parkway tunnel over to Raceway Road is currently owned and managed by the B&O Trail Association.

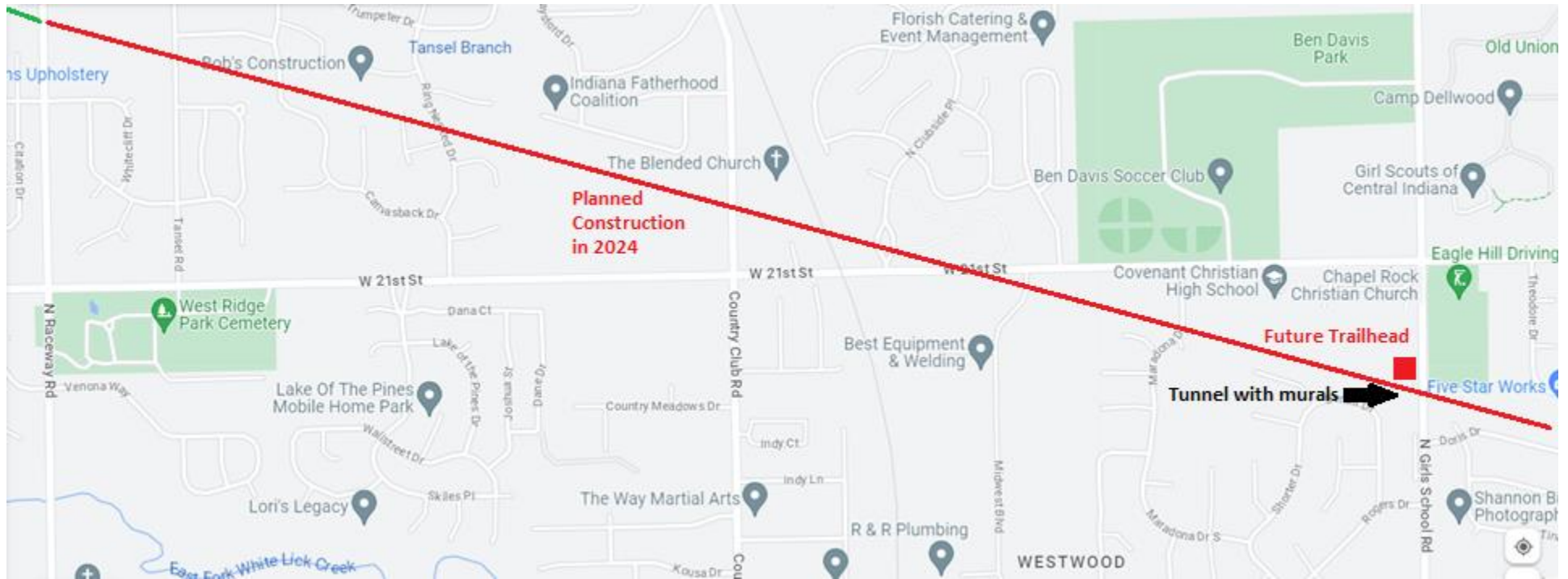

--- 70 --- 71 --- 72 --- 73 --- 74 --- 75 --- 76 --- 77 --- 78 --- 79 --- 80 --- 81 --- 82 --- 83 --- 84 --- 85 --- 86 --- 87 --- 88 --- 89

Map 5 – This undeveloped section of trail in Marion County shown in red stretches from Raceway Road over to Girls School Road. The plan is to construct this section of trail in 2024. A future trailhead with a shelter will be constructed by Chapel Rock Church and will be located in the back of their parking lot adjacent to and north of the trail just west of the Girls School Road tunnel.

Trail crossings shown here will include: Raceway Road, Tansel Road, Canvasback Drive, Ring Necked Drive, Country Club Road, an active CSX railroad trestle, Clubside Place, 21st Street, Midwest Boulevard, Maradona Drive and Girls School Road (tunnel). There will be a user-activated HAWK signal at the 21st Street crossing.

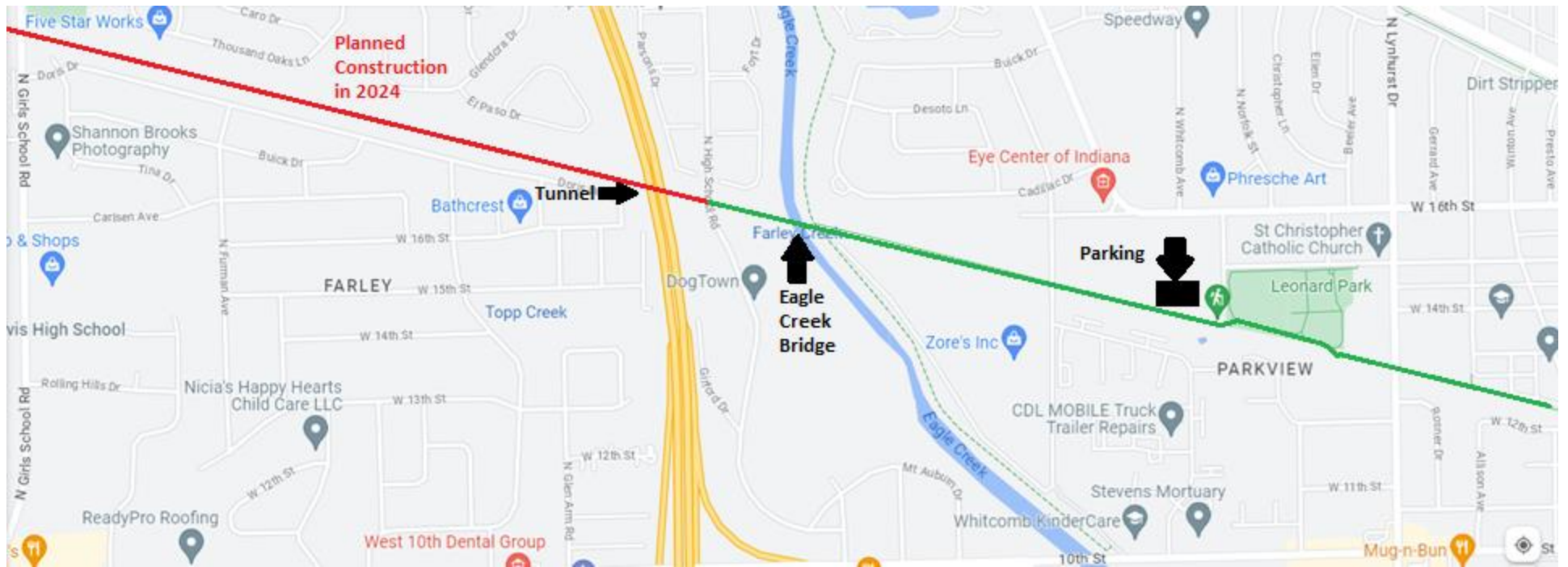

--- 88 --- 89 --- 90 --- 91 --- 92 --- 93 --- 94 --- 95 --- 96 --- 97 --- 98 --- 99 --- 100 --- 101 --- 102 --- 103 --- 104 --- 105 --- 106 ---

Map 6 – This undeveloped section of trail stretches from Girls School Road (tunnel) to High School Road. It is planned for construction in 2024. The newly constructed trail stretches from High School Road over to Lynhurst Drive. Parking and trail access is available just west of Leonard Park in the Town of Speedway. That parking lot is located at the south end of North Worth Avenue adjacent to the trail. A user-activated HAWK signal is located where the trail crosses Lynhurst Drive.

Trail crossings shown here include: Girls School Road (tunnel), I-465 (tunnel), High School Road, Eagle Creek Bridge, Mickley Avenue and Lynhurst Drive.

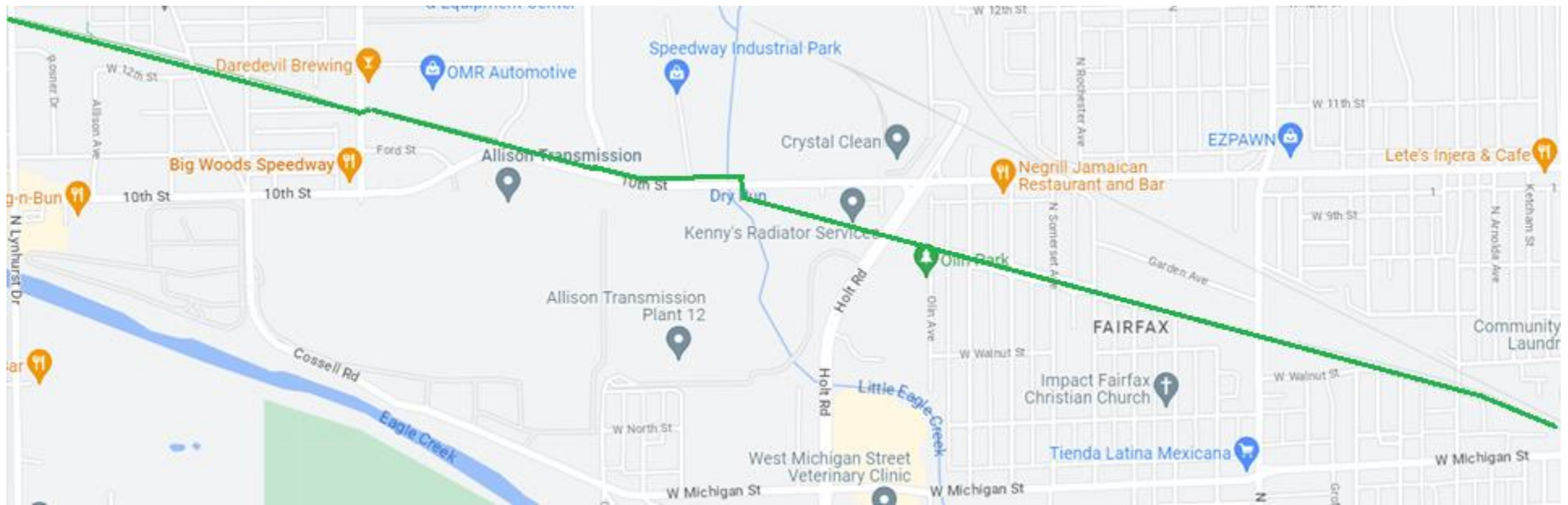

---105---106---107---108---109---110---111---112---113---114---115---116---117---118---119---120---121---122---123---

Map 7 – This developed section of trail in Marion County stretches from Lynhurst Drive over to Michigan Street. There are user-activated HAWK signals at Lynhurst Drive, 10th Street, Holt Road and Tibbs Avenue.

Crossings shown here include: Lynhurst Drive, Winton Avenue, Auburn Street, Main Street, Allison Way, 10th Street, Holt Road, Luett Avenue, Livingston Avenue, Somerset Avenue, Rochester Avenue, Tibbs Avenue, Concord Street and Michigan Street.

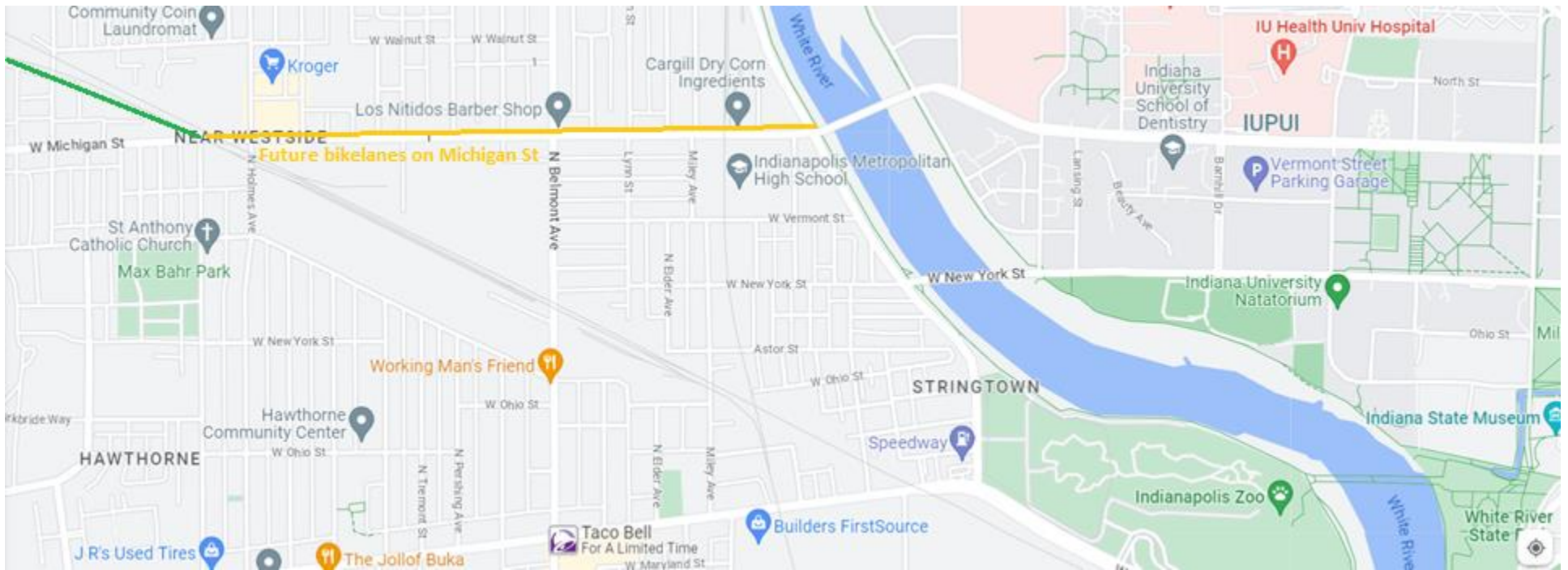

~~122 - -123 - -124 - -125 - -126 - -127 - -128 - -129 - -130 - -131 - -132 - -133 - -134 - -135 - -136 - -137 - -138 - -139 - -140 - -141-~~

Map 8 – The developed section of trail in Marion County is shown ending at Michigan Street. Dedicated bike lanes on the north side of Michigan Street are shown in yellow and are being constructed by the City of Indianapolis in 2023. These bike lanes will connect the B&O Trail over to the White River Trail. The City of Indianapolis offers a detailed map online of all of their trails city-wide at <https://maps.indy.gov/MapIndy/>

Crossings shown here include: an active railroad crossing at Michigan Street, Holmes Avenue, King Avenue, Mount Avenue, Tremont Avenue, Pershing Avenue, Sheffield Avenue, Belmont Avenue, Traub Avenue, Lynn Avenue, Elder Avenue, Miley Avenue, another active railroad crossing and then White River Parkway.